

Section: A-A

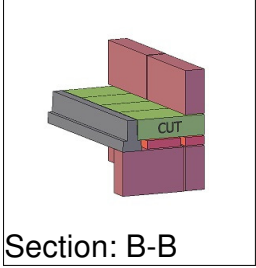

Section: B-B

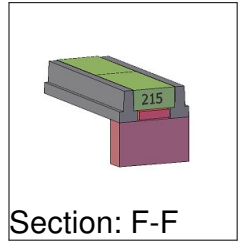

Section: F-F

RevA - revised following receipt of new information. IB 8.3.18

140mm Beam and Block bearing at all perimeters, Internal bearings 100mm

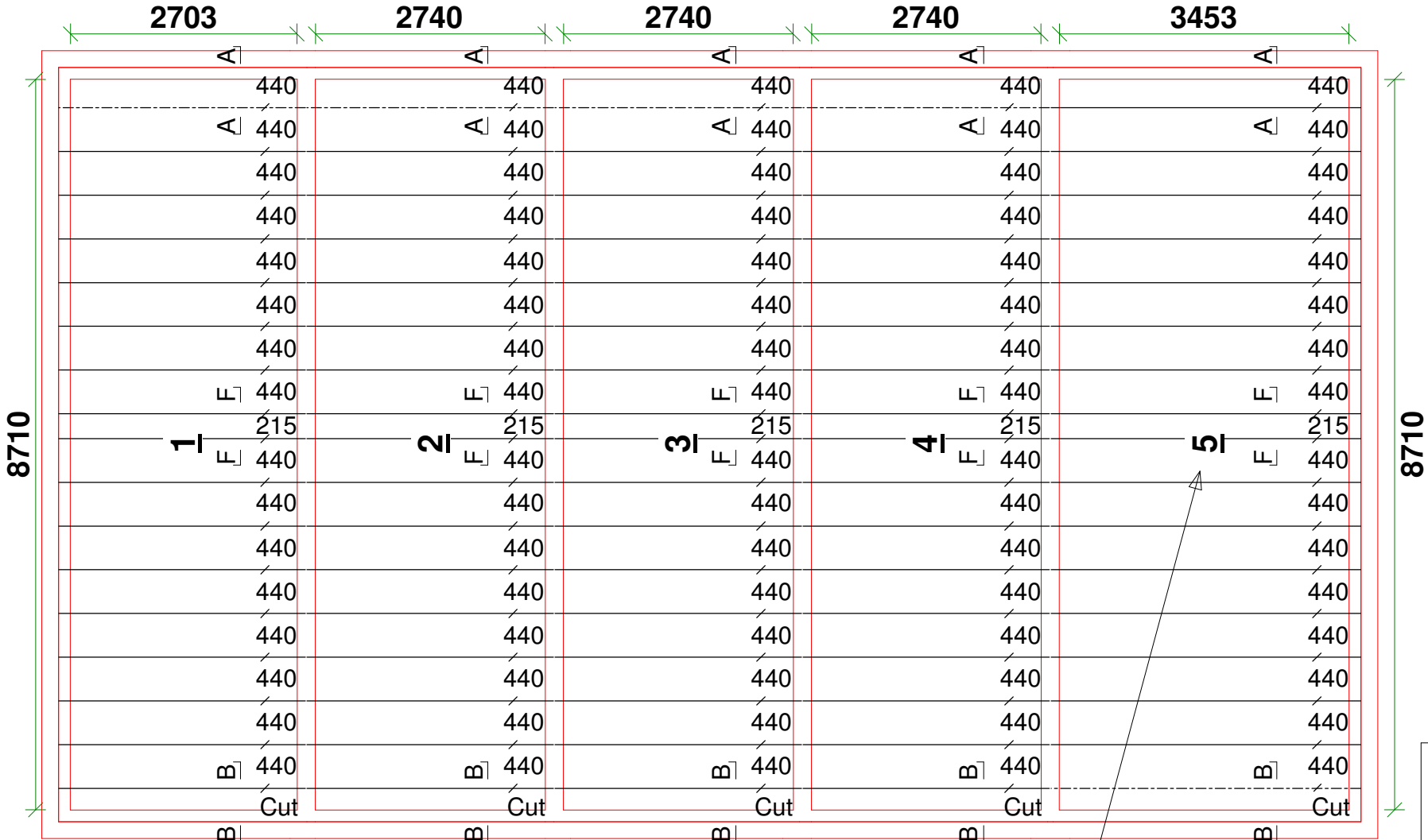
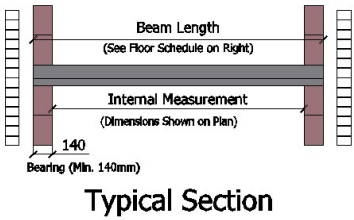

Plot 2

Internal Partitions supported by Engineer designed screed

The void under the suspended floor requires ventilation. Our air brick and vent sets are designed to be used in a standard cavity wall with minimum 50mm cavity void. It is the responsibility of the MC to find an alternative method to ventilate the void under the suspended floor.

Overall Lightweight partition load of 1.0kN/m² applied to Bay 5 only (4.65kN/m² Partition loading does not apply).

Please sign & return this drawing to indicate approval of the beam lengths and design specification. We recommend you take advice from a design professional. Submitted layouts marked as 'no comment' will be taken as fully approved.

Signed.....
Print Name.....
Date.....

Air Brick Colour
Red.....
Buff.....
Brown.....
Black.....

Loadings

Imposed Load

1.5 kN/m²

Finishes

EPS70 225mm 0.06 kN/m²

Partition loading 1000mm 4.65 kN/m²

Reinforced screed 75mm 1.80 kN/m²

Notes

1. Our quotation is based on this drawing. It is the clients responsibility to check the information on this drawing and advise Floorspan Contracts of any errors or variations immediately. Any changes may result in a new price being issued.

2. Stated loadings must not be exceeded.

3. Over wider spans a levelling screed may be necessary if timber floating floors are to be used.

4. Garage floors are designed with a 2.5kN/m² Imposed Load or a 10kN Point Load. They must be finished with a minimum 50mm thick 25N/mm2 concrete screed reinforced with 1 layer of A98 Mesh (please advise).

5. Structural double or triple beams must take priority over the position of soil/vent pipes.

6. In all cases components and workmanship will be in accordance with our technical specification and terms & conditions, a copy of which is available via www.floorspan.co.uk

Blocks Medium Density 1450kg/m³ 129m² nett

Floor Schedule

Standard Beam 150mm - EC2

Bay	No	Typ	Lgth	Ref	Bay	No	Typ	Lgth	Ref
1	17	S	T52950		2	17	S	T52950	
3	17	S	T52950		4	17	S	T52950	
5	17	S	T53700						

Floor Area

139.01 m²

Floor Weight

9.06 tonnes

Job Title

Proposed New Dwelling

Site

Rear of 65 High Street,
Upwood, Cambs.
PE26 2QE.

FLOORSSPAN

CONTRACTS

T: 01945 476161

e: enquiries@floorspan.co.uk

Drawing No

FC0200E.2 RevA

Drawn By

IB

Checked By

ND

Winfloor V5.6' Copyright © 2018 PCR Systems +44 (0)161 408 5231 supplied to Floorspan Contracts Ltd [Bld:]